

Issuances

No.	Description	Date
1	FOUNDATION PERMIT	10/06/2023
2	PERMIT SET	12/19/2023

LEGEND

- PROPERTY LINE
- IMAGINARY LOT LINE/CENTERLINE OF DEEDED (E) ROAD
- 60" CLR ACCESSIBLE PEDESTRIAN ACCESS: 1.20 MAX RUNNING SLOPE AND 2% MAX CROSS SLOPE, SLD
- 60" CLR PEDESTRIAN EXIT DISCHARGE TO PUBLIC WAY: 1.20 MAX RUNNING SLOPE AND 2% MAX CROSS SLOPE, SLD
- PEDESTRIAN PATH
- BUGGY DROP OFF
- 5' MIN X 4'-2" RESTING AREA PER 2016 CBC 403.7, GUESTROOM UNIT W/ MOBILITY FEATURES
- GUESTROOM W/ COMMUNICATION FEATURES
- LIMIT OF WORK
- PUBLIC WAY

- SITE PLAN NOTES**
- 1 FUTURE GUESTROOM BLDG TO BE SUBMITTED FOR BLDG PERMIT AT LATER DATE.
 - 2 (E)BLDG ON ADJACENT PROPERTY OWNED BY SAME OWNER AS ROSEWOOD CALISTOGA HILLS RESORT PROJECT, 1520 DIAMOND MOUNTAIN RD CALISTOGA, CA 94515
 - 3 FUTURE PRIVATE RESIDENCE TO BE SUBMITTED FOR BLDG PERMIT AT LATER DATE, WITHIN SUBDIVIDED LOTS.
 - 4 FUTURE ACCESSIBLE ELEVATOR
 - 5 FUTURE WHEELCHAIR LIFT
 - 6 FUTURE HOUSEKEEPING BLDG
 - 7 FUTURE BUGGY CART STAGING AREA

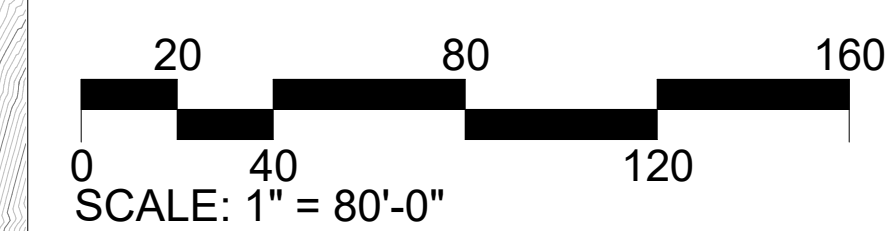

REVIEWED FOR CODE COMPLIANCE
April 18, 2024
BUREAU VERITAS NORTH AMERICA, INC.

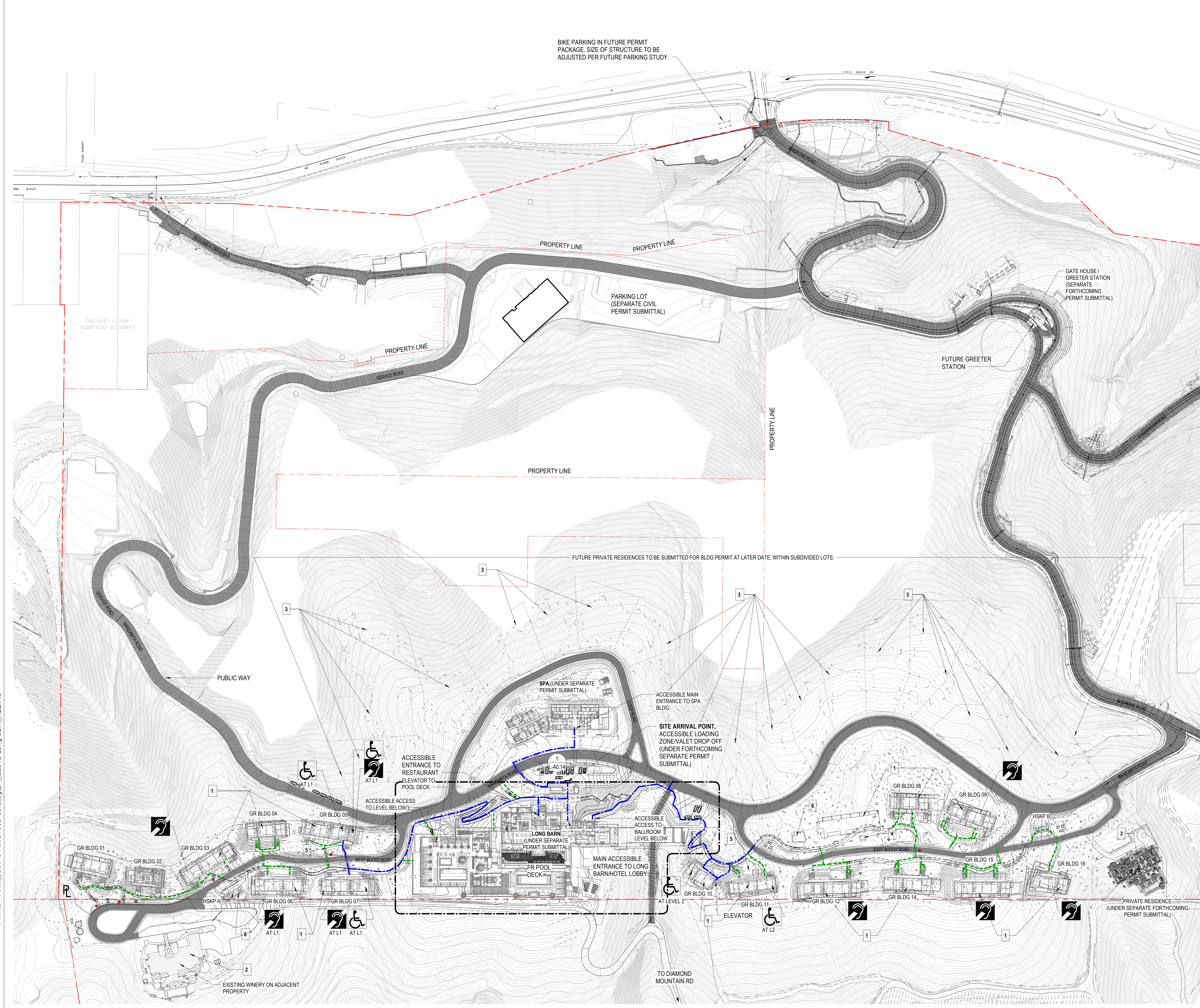

OVERALL PLAN SITE ACCESSIBILITY PLAN
11/20/2023 4:45:05 PM